

How To Set Up Your Email In Thunderbird

1. Open Mozilla Thunderbird.
2. Select "Email" under the "Create a new account" section.

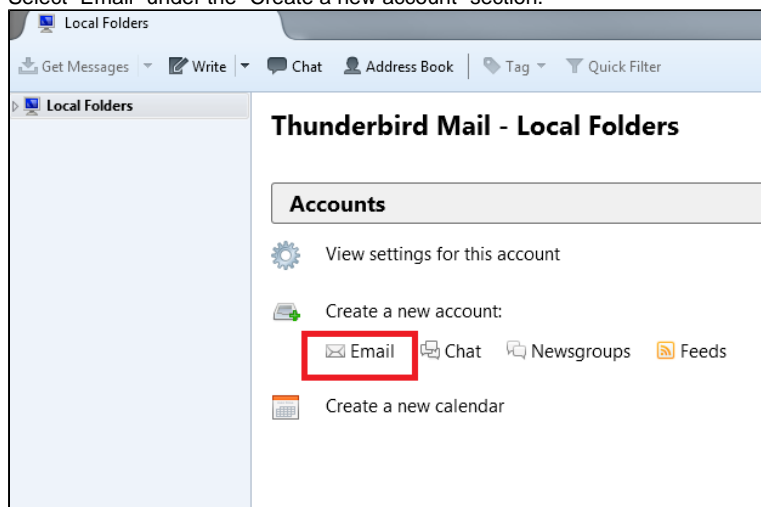

3. Click "Skip this and use my existing email".

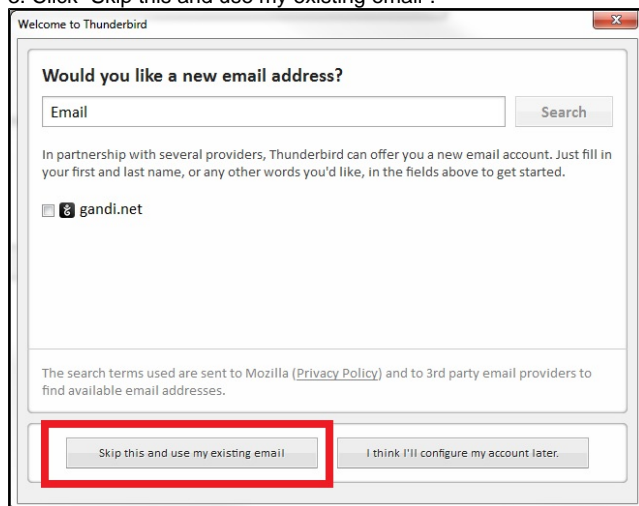

4. Enter your name in the field provided. This will appear in the "From" section when sending email.
5. In the "Email address" field, enter your full email address in all lowercase letters. For example: johndoe@yourdomain.co.uk. In the password field, enter the email account's password. Check "Remember Password" to skip entering your password each time you connect to your email account.

6. Click "Continue".

Mail Account Setup

Your name: Your name, as shown to others

Email address:

Password:

Remember password

7. Select IMAP as the type of incoming server if you plan to sync email between your devices. POP3 should be used if you would like to download all emails from the email server to your computer and not have access to them using WebMail, your mobile device, tablet or outside of ThunderBird.

8. Type chimail.uk2.net into the hostname lines for both the incoming and outgoing field. The default POP incoming port is 995 and the default IMAP incoming port is 993.

9. The outgoing port needs to be set to 465.

10. The username setting will be your email address in all lowercase letters.

11. Make sure to enable SSL/TLS for both servers. Leave the "Authentication on Normal Password" enabled for both.

12. Click the "Re-test" button to check whether you are able to successfully connect and create your account.

Your name: Your name, as shown to others

Email address:

Password:

Remember password

⚠ Thunderbird failed to find the settings for your email account.

| | Server hostname | Port | SSL | Authentication |
|-----------|--|--|------------------------------|--------------------------------------|
| Incoming: | IMAP <input type="text" value="mail.uk2.net"/> | 993 <input type="text"/> | SSL/TLS <input type="text"/> | Normal password <input type="text"/> |
| Outgoing: | SMTP <input type="text" value="mail.uk2.net"/> | 465 <input type="text"/> | SSL/TLS <input type="text"/> | Normal password <input type="text"/> |
| Username: | Incoming: <input type="text" value="user@uk2torials.com"/> | Outgoing: <input type="text" value="user@uk2torials.com"/> | | |

Related articles

Page:[How To Change An Email Password](#)

Page:[How To Add An Addon Domain in Chi](#)

Page:[How To Set Up Email Accounts On An iPhone](#)

Page:[How To Update Card Details In CHI](#)

Page:[How To Transfer A Domain OUT](#)